

INSTALLATION

1. 3UZ-FE:

INSTALL STEERING PAD SWITCH MODULATOR

Install the steering pad switch modulator with the 2 screws.

2. INSTALL DUST COVER

3. INSTALL INTERMEDIATE SHAFT ASSEMBLY

Temporarily install the intermediate shaft assembly with the bolt "A".

4. INSTALL STEERING COLUMN ASSEMBLY

- (a) Install the steering column assembly with the 4 column assembly set nuts.

Torque: 25 N·m (260 kgf-cm, 19 ft-lbf)

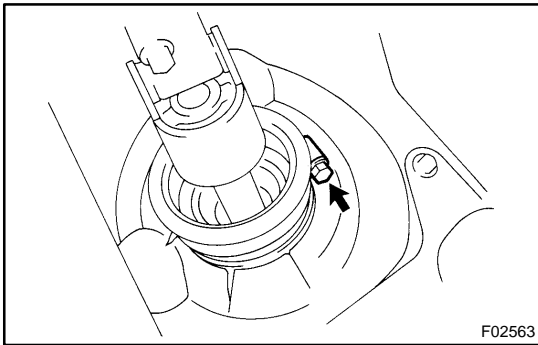

- (b) Tighten the hole cover clamp.
(c) Install the brake pedal return spring.
(d) Connect the connectors.

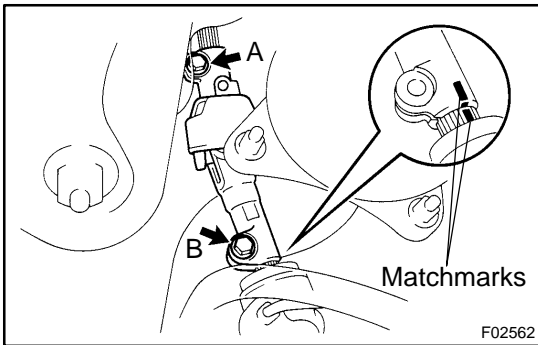

5. CONNECT INTERMEDIATE SHAFT ASSEMBLY

- (a) Align the matchmarks on the intermediate shaft and control valve shaft.

- (b) Install the bolt "B" and torque the bolt "A".

Torque: 35 N·m (360 kgf-cm, 26 ft-lbf)

6. INSTALL HEATER TO REGISTER DUCT NO. 7

7. INSTALL NO. 1 SAFETY PAD

- (a) Install the No. 1 safety pad with the 4 pad set bolts and screw.

- (b) Connect the hood lock release lever with the 2 screws.

8. INSTALL FINISH PLATE AND END PAD

9. INSTALL NO. 1 UNDER COVER

- (a) Connect the connectors.

- (b) Connect the DLC3.

- (c) Install the No. 1 under cover with the 3 screws.

10. INSTALL SPIRAL CABLE (See page [BE-34](#))

11. INSTALL COMBINATION SWITCH WITH SPIRAL CABLE

- Install the combination switch with spiral cable with the 3 screws.
- Connect the airbag connector.
- Connect the 4 connectors.

12. INSTALL UPPER AND LOWER COLUMN COVERS

Install the upper and lower column cover with the 3 screws.

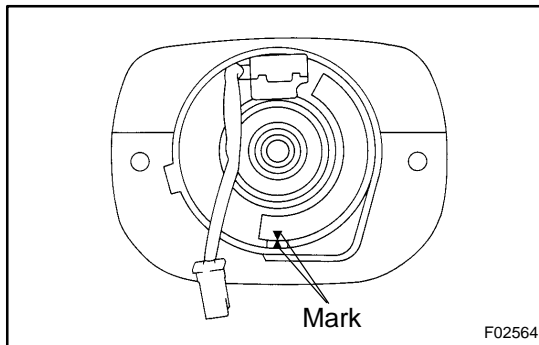
**13. CENTER SPIRAL CABLE**

- Check that the front wheels are facing straight ahead.
- Turn the spiral cable counterclockwise by hand until it becomes harder to turn.
- Then rotate the spiral cable clockwise about 3 turns to align the mark.

HINT:

The spiral cable will rotate about 3 turns to either left or right of the center.

14. INSTALL STEERING WHEEL

- Align the matchmarks on the steering wheel and main shaft.

- Install the wheel set nut.

Torque: 50 N·m (510 kgf-cm, 37 ft-lbf)

- Connect the connector.

15. INSTALL STEERING WHEEL PAD**NOTICE:**

- **Never use airbag parts from another vehicle. When replacing parts, replace with new ones.**
- **Make sure the wheel pad is installed to the specified torque.**
- **If the wheel pad has been dropped, or there are cracks, dents or other defects in the case or connector, replace the wheel pad with a new one.**
- **When installing the wheel pad, take care that the wirings do not interfere with other parts and are not pinched between other parts.**

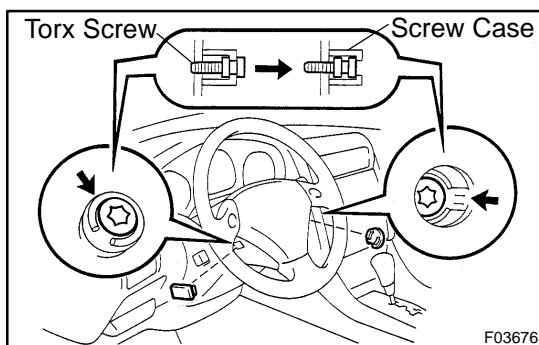

- Connect the airbag connector.
- Install the steering wheel pad after confirming that the circumference groove of the torx screw is caught on the screw case.

- Using a torx socket wrench, torque the 2 screws.

Torque: 8.8 N·m (90 kgf-cm, 78 in.-lbf)

- 2JZ-GE:

Install the steering wheel lower No. 2 and No. 3 covers.

- (e) 3UZ-FE:
Install the steering wheel lower No. 2 cover and pad
switch modulator cover.

16. CHECK STEERING WHEEL CENTER POINT